

PI15

High Power, Two-way Passive System

P.I.

Features

- Full-range, passive two-way system
- LF driver with demodulating ring for distortion-free vocals
- User-rotatable horn
- Vertical and horizontal mounting option
- Cloth-backed perforated steel grille
- Trapezoid enclosure with textured finish
- 8Ω nominal impedance
- Internal crossover network with LF and HF driver protection
- Twin NL4 connectors
- Multiple M8 rigging inserts

Applications

- Education
- Hospitality
- Small performance spaces
- Government
- Public Spaces

The PI15 is a high-power, passive two-way system designed applications bars that require performance and output from a single enclosure.

It features a powerful 15" (380mm)/3" (75mm) voice coil LF drive unit, and a 1" (25mm) exit HF compression driver with a 1.75" (44mm) polyimide diaphragm for extended high frequency response. Its 80° x 50° coverage pattern is ideal for medium-throw applications, and it delivers superior vocal performance at very high sound levels without harshness.

The enclosure is constructed from 15mm engineered wood fibre and finished in black textured paint. A cloth-backed protective steel grille protects the drivers, and M8 inserts are provided for eyebolt suspension and installation.



PI15

High Power, Two-way Passive System

P.I.

Technical Specifications

TYPE	High-power, passive two-way system
FREQUENCY RESPONSE (with preset)	58Hz - 18kHz \pm 3dB -10dB @ 46Hz
DRIVERS	LF: 15" (380mm)/3" (75mm) voice coil, ferrite motor system HF: 1" (25mm) exit/1.7" (44mm) voice coil, polyimide dome compression driver
RATED POWER	500W (AES), 2000W (Peak)
RECOMMENDED AMP	VIA5002
SENSITIVITY	99dB
MAXIMUM SPL	126dB continuous, 132dB peak
NOMINAL IMPEDANCE	8 ohms
DISPERSION (-6dB)	80° H x 50° V (user-rotatable)
CROSSOVER	2.3kHz passive
ENCLOSURE	Trapezoid
FINISH	Black textured paint
PROTECTIVE GRILLE	Black perforated steel with scrim cloth backing
CONNECTORS	2 x NL4 type
PIN CONNECTIONS (INPUT)	1+/-
PIN CONNECTIONS (LINK)	1+/- to 1+/-
FITTINGS	10 x M8 inserts
DIMENSIONS	(W) 427mm x (H) 690mm x (D) 417mm (W) 16.81ins x (H) 27.18ins x (D) 16.41ins
WEIGHT	28kg (61.73lbs)

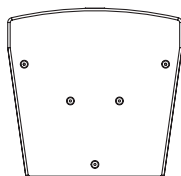
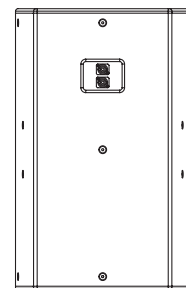
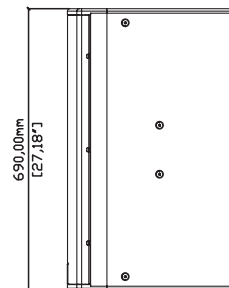
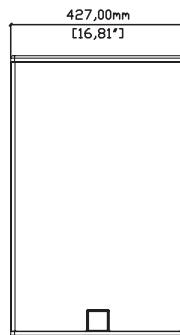
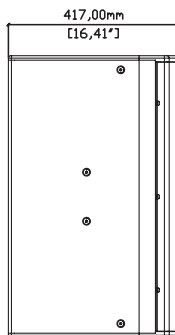
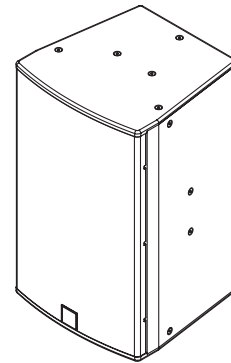
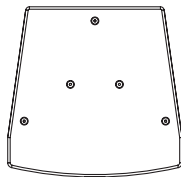

PI15

Martin Audio Ltd
Century Point, Halifax Road, High Wycombe
Buckinghamshire HP12 3SL, England

Telephone: +44 (0) 1494 535 312
Facsimile: +44 (0) 1494 438 669
Email: info@martin-audio.com

