

SX118 User Guide



Copyright © 2026 Martin Audio Limited
Publication date 2026-02-04



Table of Contents

Introduction	3
Optional accessories	4
Set of four castors WHEELKIT	4
Weatherised connector cover WRKIT	4
Transit cover SXTC118	4
M10 eye bolt HTKCT06	4
Wind-up telescopic pole ASF20071	4
Connecting the SX118	6
Weatherising the SX118	7
To fit the weatherised connector cover	7
Installing outdoors	7
Fitting castors	8
To fit castors	8
Adjusting brackets for the transit cover	9
To adjust brackets for the transit cover	9
Flying a single SX118	12
To fly a single SX118	12
Installing a pole	13
To install a pole	13
SX118 amplifier compatibility	14
Amplifier compatibility legend	14
System controllers	15
Using other controllers	15
System design	16
To download Display 3	16
EASE files	16
3D SketchUp file	16
Revit family	16
DWG file	16
Other SX subwoofers	17
SX118 specification	19
SX118 technical drawing	20
Troubleshooting	21
Technical support	21
Service	21
Warranty	21
Unpacking	21
Recycling	21

Introduction



The SX118 is a compact, high-performance subwoofer that extends the system's low-frequency range down to 47 Hz and delivers exceptional output for its size.

It features a long-excursion 18" (460 mm) driver with a 4" (100 mm) voice coil, a water-resistant cone and a triple-roll surround in a compact reflex enclosure. The driver design maximizes output while minimizing power compression and distortion. The four large-area reflex ports reduce air turbulence at high levels.

The enclosure is constructed from multi-laminate birch ply, finished with a durable polyurethane coating and fitted with a Zintec grille, twin grab handles, skids, flying inserts for installation and a threaded pole socket for mounting point-source loudspeakers or up to four WPM enclosures as a simple plug-and-play system.

The SX118 is supplied without castors as standard, but they're available as an optional accessory along with a transit cover. Adding an optional connector cover makes the SX118 fully weather-resistant and suitable for outdoor use. The SX118 is available in black (RAL 9005) or white (RAL 9016).

This user guide describes the version of the SX118 that was in production from 2019 to 2025. From 2026 the SX118 was superseded by the SX118+. For differences between the SX118 and the SX118+, see the SX118+ user guide.

Optional accessories

Set of four castors WHEELKIT

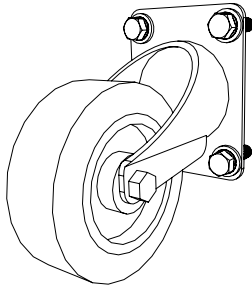

- Four heavy-duty 10 cm (4 in) swivel castors
- Fittings: 16 x M8 hex head bolts, 16 x flat washers and 16 x spring washers
- Compatible with SX115, SXC115, SXC118, SX215, SX118, SXC118, SXC118, SX218, SXP118, SXP218, Q118, Q218, X115, X118, X218, XP118, SXH218 and SXHF218

Weatherised connector cover WRKIT

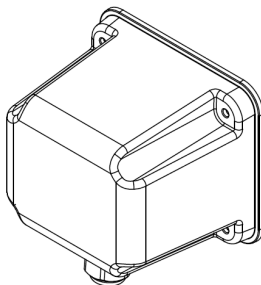

- Weatherised connector cover to protect the NL4 speaker connection and prevent water ingress
- Upgrades compatible subwoofers to an IP rating of IP24
- Compatible with SX115, SX215, SX118, SXC118, SXC118, SX218, SXH218 and SXHF218
- Two knockout holes, one on the side and one on the underside, allowing you to fit two cables or to choose where to fit one cable
- Available in black only
- Contents of kit: connector cover, gasket, cable gland, lock nut, four cap head screws (M4 x 25 mm) and four fibre washers (M4)

Transit cover SXTC118

- Tour grade transit cover
- Cut outs for easy access to handles
- Protects the SX118 in transit

M10 eye bolt HTKCT06

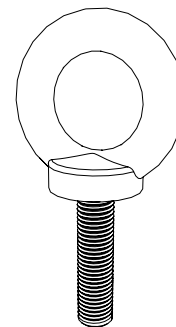

- M10 eye bolt for flying individual speakers
- Bolt size: 10 mm x 1.5 mm thread size
- Shank length: 35 mm (1 3/8 in)
- Working load limit: 740 kg (1,628 lbs)
- Material: Forged steel
- Weight: 120 g (0.27 lbs)

Wind-up telescopic pole ASF20071

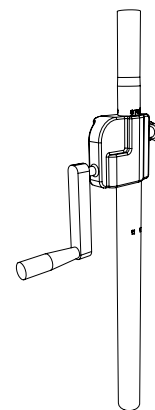

- Wind-up telescopic pole for mounting speakers on subwoofers

- Rugged steel pole with wind-up handle to allow you to raise and lower the speaker
- Locking screw and safety button
- Diameter: 35 mm (1 3/8 in) to fit standard top-hat fittings of portable speakers
- M20 threaded fitting to attach to the subwoofer
- Maximum load: 35 kg (77.2 lb)
- Pole length: 709 mm (27.9 in) to 1121 mm (44 in) including the section inside the top-hat fitting but excluding the threaded section that screws into the subwoofer

Connecting the SX118

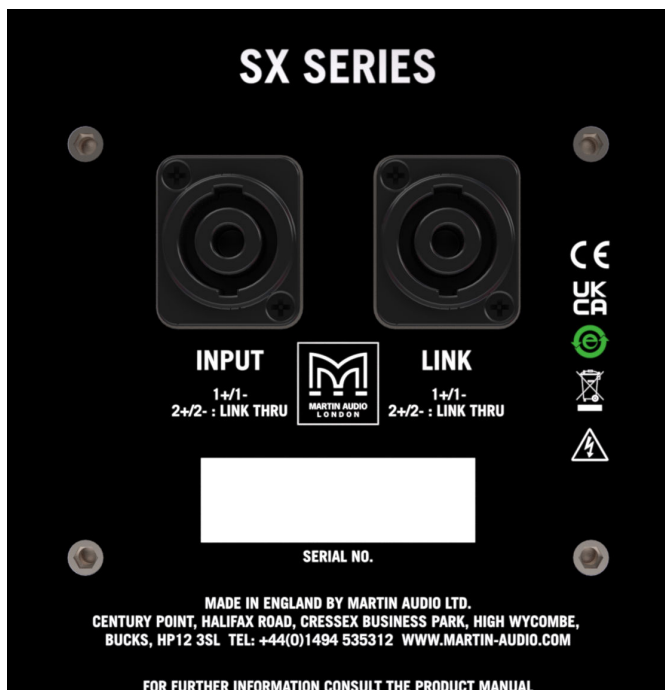

The SX118 has two NL4 sockets on the back panel, labelled INPUT and LINK. Despite the labels, the two sockets are the same, so you can use them either way round. However, we recommend you use them as labelled to simplify cabling checks. For both sockets, the pins connect as follows:

- Pins 1+/1– connect to the driver and link through to pins 1+/1– of the other socket.
- Pins 2+/2– link through to pins 2+/2– of the other socket.

Weatherising the SX118

To weatherise the SX118 for outdoor use, you just need to fit an optional weatherised connector cover [WRKIT \(page 4\)](#). The rest of the subwoofer is already prepared.

The connector cover protects the NL4 connection and prevents water ingress. It upgrades the SX118 to an IP rating of IP24.

To fit the weatherised connector cover

1. Remove one of the two knockouts from the connector cover. The knockout to use depends on your preferred cable angle. If you are using a link cable, remove both knockouts.
2. Fit the cable gland.
3. Feed the speaker cable through the gland and attach an NL4 connector. If the cable already has an NL4 connector, you will need to remove it first.
4. Remove the four screws from the connector panel on the back of the sub.
5. Plug in the NL4 connector.
6. Hold the cover and gasket in position and pull any excess cable through the cable gland.
7. Secure the cover using the fittings from the kit: these are four cap socket screws (M4 x 25 mm) and four M4 fibre washers.

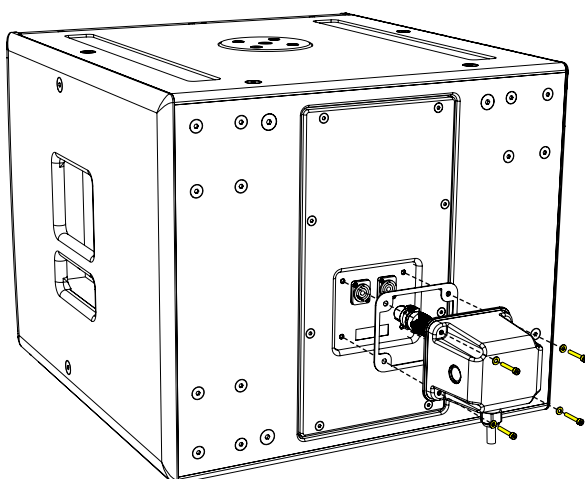

8. Tighten the cable gland to ensure a waterproof seal.

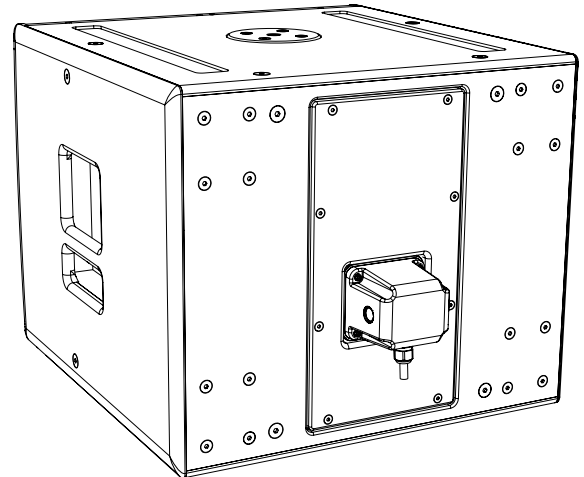

Installing outdoors

When installing a weatherised SX118 outdoors:

- Install with a slight downward tilt whenever possible to improve water drainage from the cabinet. Avoid any upward tilt.
- Provide overhead protection where you can, such as a porch, tent or external roof. This helps prevent direct exposure to rain.

Fitting castors

To fit castors to the SX118 you need an optional [WHEELKIT \(page 4\)](#) accessory. This is a set of four swivel castors along with all required bolts and washers.

To fit castors

1. Remove the four sets of four M8 counter-sunk screws from the back of the SX118.

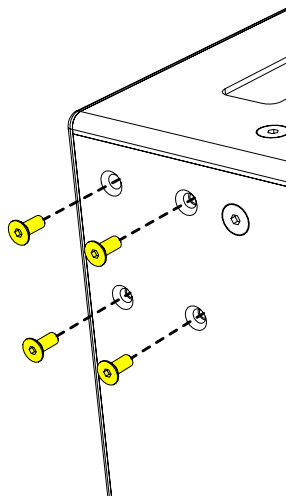

2. Bolt each castor in place using the fittings from the kit.

Order of fittings: cabinet, castor, flat washer, spring washer, bolt.

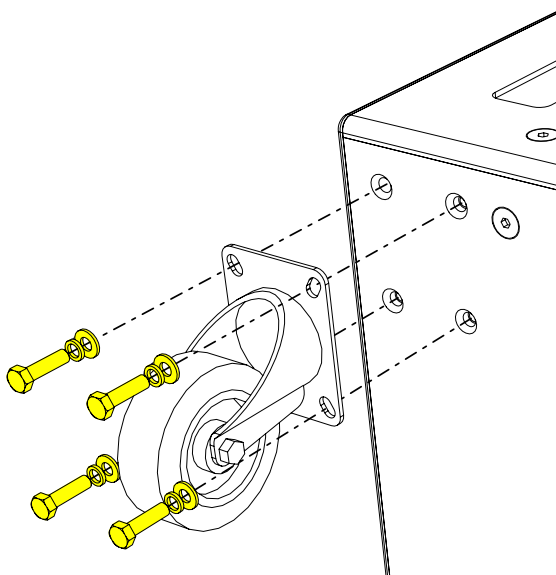

Make sure you use the bolts from the kit. The screws from the cabinet aren't suitable.

Adjusting brackets for the transit cover

To protect the SX118 in transit, use the optional transit cover. Before you use this cover for the first time, you need to adjust four brackets at the front four corners of the cabinet. The brackets hold the cover's protective board clear of the grille to prevent dents and avoid scratches.

To adjust brackets for the transit cover

1. Remove the screws from the top and bottom of the grille.

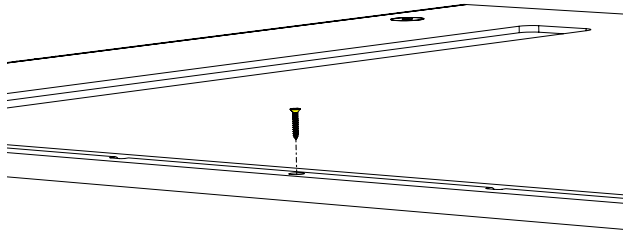

2. Insert a flat-blade screwdriver into one of the grille slots and carefully ease the grille out of the slot.

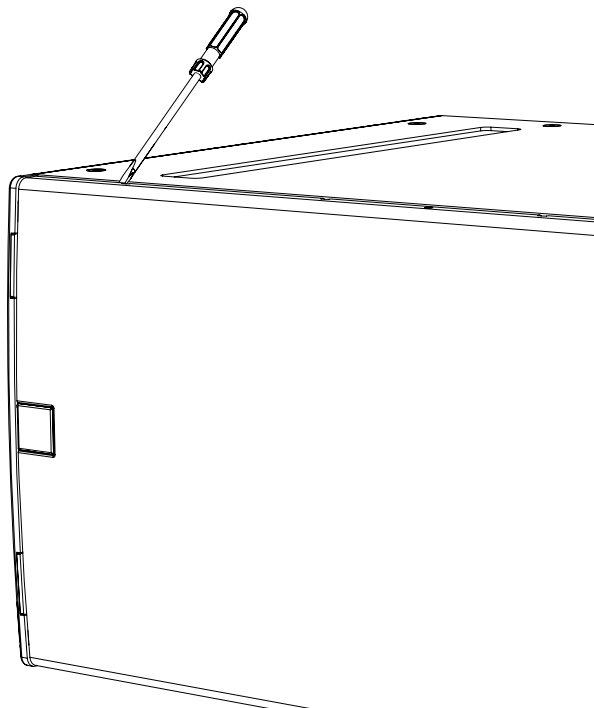

3. Unscrew the six screws holding the grille support in place at the side of the cabinet.

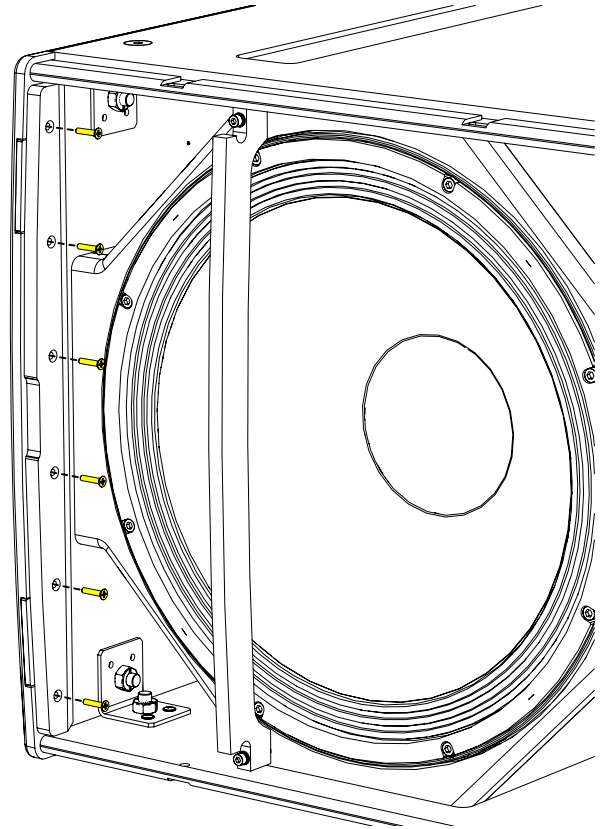

4. Remove the grille support.

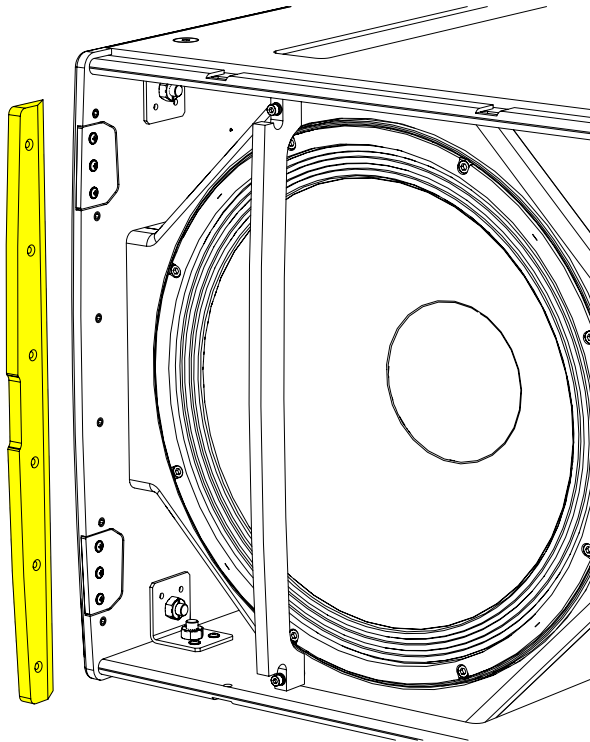

bracket extends about 20 mm from the front edge of the cabinet.

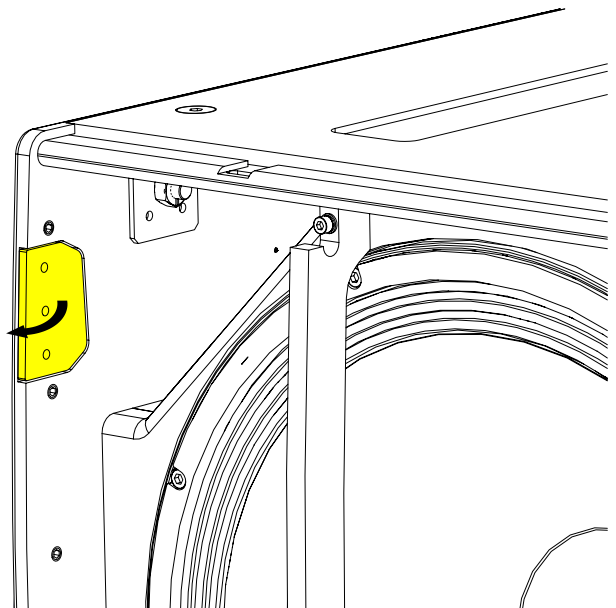

5. Unscrew the three screws holding the bracket in place.

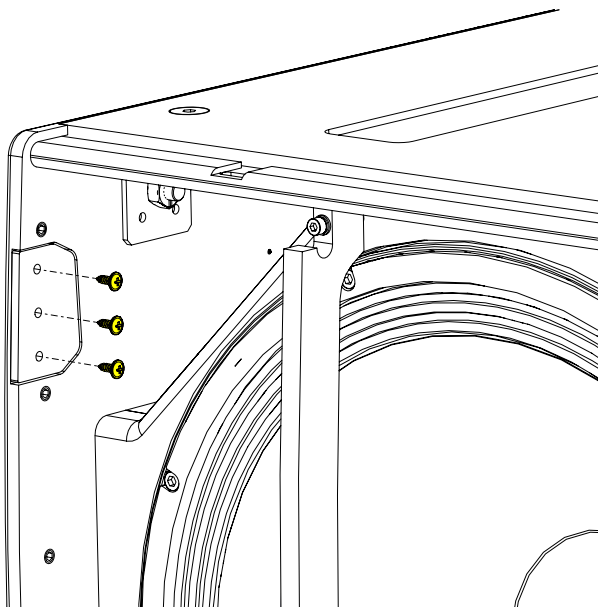

7. Screw the bracket back in place and repeat for the other bracket.

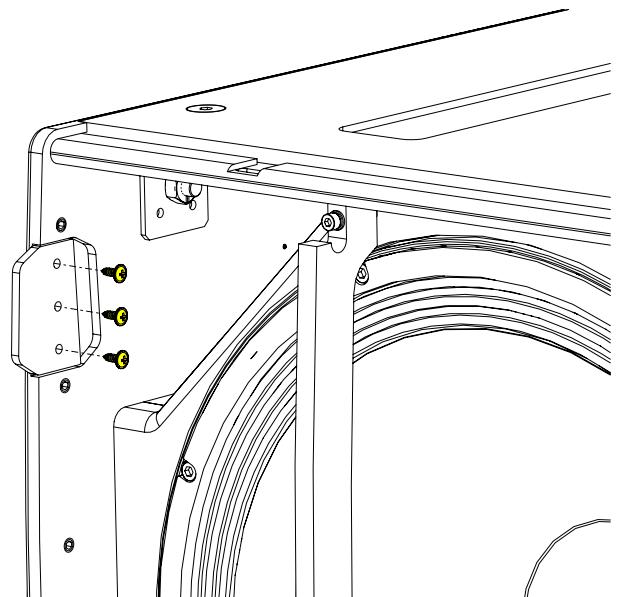

6. Turn the bracket over (rather than rotating it) so the slope aligns with the cabinet's curved contour and the

8. Screw the grille support back in place.

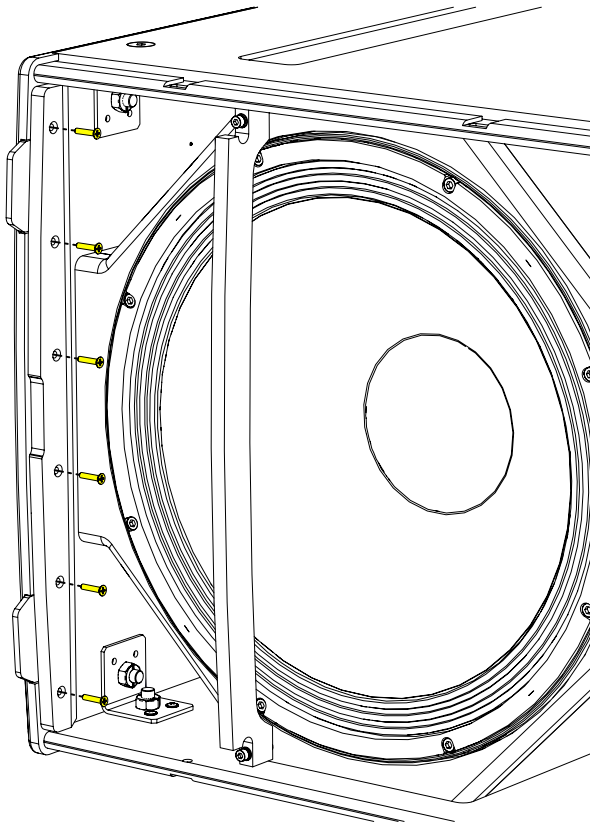

the front of the cabinet so they can hold the transit cover's protective board clear of the grille.

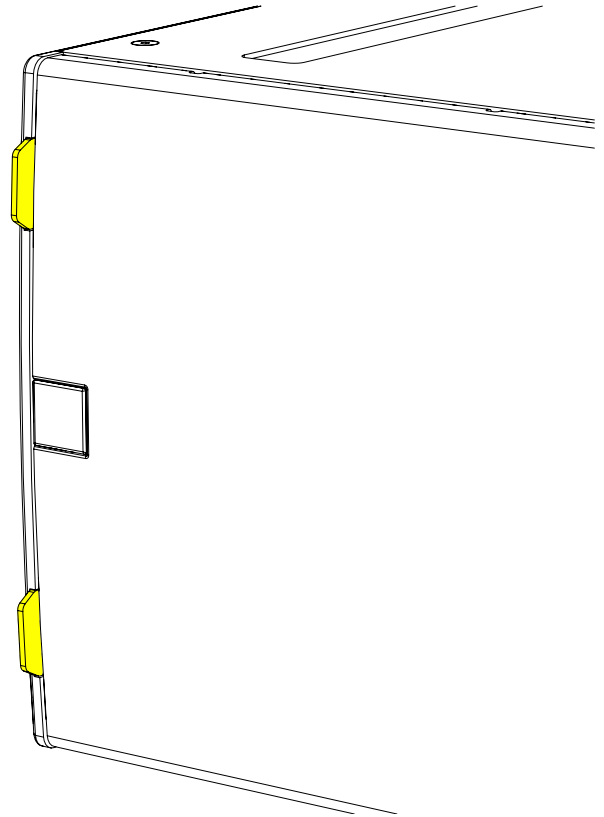

9. Repeat the steps above for the grille support and brackets on the other side of the cabinet.
10. Replace the grille and screw it in place at the top and bottom. The brackets now project slightly from

Flying a single SX118

You can fly individual SX118 subwoofers from ceilings, trusses or poles by using Martin Audio M10 shouldered eye bolts (HTKCT06) and appropriately rated steel ropes or chains.



Eye bolts allow you to fly single subwoofers only.

Note that Martin Audio shouldered eye bolts are manufactured from cast steel and are specifically engineered and rated for flown applications.



Don't use eye bolts from other manufacturers, as this could be dangerous.

Forged-steel eye bolts available from DIY suppliers are **not** strong enough. Even cast or machined eye bolts rated for purpose can be unsuitable, as they can have wide shoulders that cause the bolt to tighten against the cabinet rather than the thread.

The SX118 has 16 x M10 mounting points: four on the top, four on the bottom, two on the left, two on the right and four on the back. All of these mounting points have internal brackets rather than simple inserts. When you screw in an eyebolt, it threads into the internal bracket.



Flying heavy equipment in public spaces is extremely dangerous. Make sure the installer uses appropriately rated equipment and has suitable qualifications and experience.

Install the safety bond fixing in a different place from the main fixings. This is so that it can support the cabinet if the main fixings fail.

3. Connect the eye bolts and fixings using suitably rated steel rope or shackles and chains.

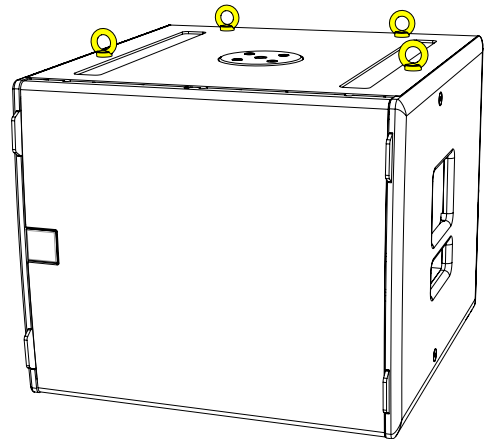

To fly a single SX118

1. Remove some of the M10 counter-sunk screws from the SX118 (usually from the top) and screw in M10 eye bolts. We recommend five eye bolts: four to fly the subwoofer and one as a redundant safety bond.
2. Install suitably rated fixings, such as sleeve anchors for ceilings, or girder clamps for trusses and scaffolding.

Installing a pole

The SX118 has a top-mounted M20 thread plate for installing a screw-mounted pole. This lets you pole-mount speakers with standard top hat fittings such as CDD-LIVE, WPM and MLA Mini. If you fit a Martin Audio pole-mount adaptor (part ASF20045) to the top of the pole, you can also mount speakers on yokes. This lets you pole-mount speakers that don't have top hat fittings, such as CDD and FlexPoint.

The Martin Audio [wind-up telescopic pole ASF20071 \(page 4\)](#) is ideal for use with the SX118 and lets you adjust the speaker height. It also makes mounting easier as you can install the speaker at a low level and then wind it up into position. This pole supports loads up to 35 kg (77.2 lbs). If you set the pole at the level marked "Preset" the maximum load increases to 56 kg (123.5 lbs), which lets you mount up to four WPM or four MLA Mini.

To install a pole



Before you start, check that the speaker's weight is within the load limit of the pole.

1. Place the SX118 on a flat, level and stable surface with the round plate on the top.
2. Screw the threaded pole into the M20 plate until it is fully tightened and secure.

SX118 amplifier compatibility

Amplifier	Channels	Channels used	One SX118 per channel (8 ohm)	Two SX118 per channel (4 ohm)	Three SX118 per channel (2.67 ohm)	Four SX118 per channel (2 ohm)
iK41	One channel	1 of 4	No	No	No	No
	Two channels bridged	2 of 4	Yes	−1.2 dB	No	No
iK42	One channel	1 of 4	−1.2 dB	−1.2 dB	−1.7 dB	−2.0 dB
	Two channels bridged	2 of 4	Yes	Yes	No	No
iK81	One channel	1 of 8	−2.0 dB	No	No	No
	Two channels bridged	2 of 8	Yes	−2.0 dB	No	No
VIA5004	One channel	1 of 4	No	No	No	No
	Two channels bridged	2 of 4	−1.0 dB	−2.0 dB	No	No
VIA2502	One channel	1 of 2	No	No	No	No
	Two channels bridged	2 of 2	−1.0 dB	−2.0 dB	No	No
VIA5002	One channel	1 of 2	−1.0 dB	−2.0 dB	No	No
	Bridging not available	NA	NA	NA	NA	NA
VIA2004	One channel	1 of 4	No	No	No	No
	Bridging not available	NA	NA	NA	NA	NA

Amplifier compatibility legend

Yes	The amplifier channel can deliver the required power to achieve the full pink noise rated output of the loudspeaker, providing a reasonable amount of headroom for dynamic music content.
−1.0 dB	The amplifier channel provides sufficient power to meet the loudspeaker's RMS requirements (based on a 20 Hz – 20 kHz sine wave). However, it is unable to deliver the 6 dB peaks found in the AES pink noise test signal, which more accurately reflects the demands of dynamic music content. The table shows the shortfall in dynamic headroom, expressed in decibels.
No	The amplifier channel does not meet the loudspeaker's pink noise or RMS power requirements and is therefore not recommended. However, it may still be suitable if the application does not demand the full rated output of the loudspeaker.
NA	Not available: channel bridging isn't available with this amplifier.

Note that it is far more likely that an underpowered amplifier will damage a loudspeaker than one with excess power. Modern limiters in speaker presets can safely manage the amplifier's output. However, driving a system into distortion due to an insufficiently powered amplifier can cause heat buildup and lead to voice coil burnout, which is the most common form of loudspeaker damage.

If you need assistance with system design, please contact [Technical Support \(page 21\)](#).

System controllers

For system controllers, we recommend the Martin Audio DX0.4, DX0.6 or DX4.0. Note that if you use an iKON amplifier, you don't need a system controller as these amplifiers have on-board system processing. For further details, see our website martin-audio.com.

Using other controllers

If you use a controller from another manufacturer, you need to configure settings such as crossovers, limiters and equalisation points. You can find these settings in our **Loudspeaker parameter spreadsheet**, which we provide as a free download. For details of how to use the spreadsheet, read the instructions in the spreadsheet or watch the video guide.

To download the loudspeaker parameter spreadsheet

1. Go to our website martin-audio.com.
2. Select **Support > Loudspeaker Settings**.
3. Scroll to **CURRENT-PRODUCT-PARAMETERS** and click **DOWNLOAD**.

To watch the video guide

1. Go to our website martin-audio.com.
2. Select **Support > Loudspeaker Settings**.
3. Scroll to **PARAMETER VIDEO** and click **VIDEO**.

System design

To design your system and decide on the best positions for speakers and subs, we recommend Martin Audio **Display 3** software, which we provide as a free download from our website.

Display 3 allows you to model your space and experiment with various system configurations and speaker positions. Display 3 predicts the performance of your experimental configurations, allowing you to optimise the performance of your system at the design stage.

To download Display 3

1. Visit our website martin-audio.com.
2. Select **Support > Software/Firmware**.
3. Scroll to **Display 3** and click **Download**.

EASE files

You can model the SX118 in **EASE** by downloading a ZIP file of high-resolution GLL files, available as a free download from our website. Alternatively, you can download a set of GLL files that are compatible with **EASE Focus**.

Note that we recommend using **Display 3** rather than **EASE** or **EASE Focus**.

To download GLL files

1. Visit our website martin-audio.com.
2. Select **Support > GLL and CLF Data**.
3. Scroll to **SX Series** or **EASE Focus** and click **Download**.

3D SketchUp file

For modelling the SX118 in **SketchUp**, we provide a 3D SketchUp file as a free download.

To download the 3D Sketchup file

1. Visit our website martin-audio.com.
2. Select **Products > Product List** and click on **SX118**.
3. Select the **Technical drawings & 3D models** section and click **SKP-BLACK**.
4. For accessories, select the **Accessories** section and click **SKP-B**.

Revit family

For modelling the SX118 in Revit, we provide a Revit family as a free download.

To download the Revit family

1. Visit our website martin-audio.com.
2. Select **Products > Product List** and click on **SX118**.
3. Select the **Technical drawings & 3D models** section and click **REVIT FILE**.

DWG file

For viewing the SX118 technical drawing in CAD software (such as AutoCAD), we provide a DWG file as a free download.

To download the DWG file

1. Visit our website martin-audio.com.
2. Select **Products > Product List** and click on **SX118**.
3. Select the **Technical drawings & 3D models** section and click **DWG**.
4. For DWG files for accessories, select the **Accessories** section and click **DWG**.

Other SX subwoofers

The SX Series subwoofers are a range of sub bass enclosures designed to complement Martin Audio full range systems. The range encompasses installation and touring subs, from ultra-compact miniature subs perfect as discreet, unobtrusive installation partners to the ADORN or CDD ranges, right up to very high output twin 18" models perfect for touring use in conjunction with Wavefront Precision line arrays. The larger models are built to be weather resistant and, when the NL4 connectors are protected, are suitable for occasional outdoor use as a portable system or for outdoor installation as long as they are not directly exposed to the elements. Depending on the model, the NL4 connectors are protected in one of two ways, as shown in the table below. Some models use an optional connector cover that

shields the two rear NL4 sockets. The newest models do not use a connector cover and instead have three special NL4 sockets that provide an IP rating of IP54 when you use the correct weather-resistant connectors and fit NL4 sealing plugs in any unused sockets.

The range includes two powered, Dante equipped subwoofers. These are an ideal partner for CDD-LIVE. The range also includes three marine passive subwoofers for use in saltwater environments such as cruise ships and beach-side locations.

The optional accessories include eye bolts for flying smaller models, frames for flying larger models, and castors and rugged transit covers for use in touring.

For further details, visit our website martin-audio.com.

Passive SX subwoofers

		Castors	Transit cover	Weatherised connector cover	Weatherised NL4 connectors and LEDs	Marine version available
SX110	10" passive subwoofer	No	No	No		
SX210	Dual 10" passive subwoofer	No	No	No		
SX112	12" passive subwoofer	No	No	No		Yes
SX212	Dual 12" passive subwoofer	No	No	No		
SX115	15" passive subwoofer	Optional	Optional	Optional		
SXC115	15" passive cardioid subwoofer	Optional	Optional	No		
SXCF115	15" passive cardioid flown subwoofer	Optional	Optional	No		
SX215	Dual 15" passive subwoofer	Optional	Optional	Optional		
SX118	18" passive subwoofer	Optional	Optional	Optional		Yes
SX118+	18" passive subwoofer	Optional	Optional	No	Yes	
SXC118	18" passive cardioid subwoofer	Optional	Optional	Optional		
SXCF118	18" passive cardioid flown subwoofer	Optional	Optional	Optional		
SX218	Dual 18" passive subwoofer	Optional	Optional	Optional		Yes
SX218+	Dual 18" passive subwoofer	Optional	Optional	No	Yes	
SXH218 (up to 2025)	Hybrid® horn/reflex, dual 18" passive subwoofer	Supplied	Optional	Optional		
SXH218 (from 2026)	Hybrid® horn/reflex, dual 18" passive subwoofer	Supplied	Optional	No	Yes	
SXHF218 (up to 2025)	Hybrid® horn/reflex, dual 18" passive flown subwoofer	Supplied	Optional	Optional		
SXHF218 (from 2026)	Hybrid® horn/reflex, dual 18" passive flown subwoofer	Supplied	Optional	No	Yes	

Powered SX subwoofers

		Castors	Transit cover	Rain cowl
SXP118	18" powered portable subwoofer	Optional	Optional	Optional
SXP218	Dual 18" powered portable subwoofer	Optional	Optional	Optional

SX118 specification

Type	Compact, direct radiating subwoofer
Frequency response ¹	47 Hz – 150 Hz \pm 3 dB, –10 dB @ 41 Hz
Driver	18" (460 mm) with 4" (100 mm) voice coil, long-excursion ferrite magnet, waterproof cone
Rated power ²	1,000 W AES, 4,000 W peak
Recommended amplifier	iK42 or iK81 (page 14)
Sensitivity ³	102 dB
Maximum SPL ^{2,3}	132 dB continuous, 138 dB peak, 144 dB peak with crest factor 4
Nominal impedance	8 ohm
Dispersion	Omni-directional or cardioid when paired
Enclosure	Multi-laminate birch plywood
Finish	Black (RAL 9005) or white (RAL 9016) textured paint
Grille	Perforated Zintec steel
Connectors	2 x NL4
Pin connections (input)	1+/1–
Pin connections (link)	1+/1– linked to 1+/1– 2+/2– linked to 2+/2–
Fittings	2 x large skids on base with mating channels on top M20 top-mounted thread plate for optional pole Two bar handles, one on each side 16 x M10 mounting points for optional eye bolts: 4 on top, 4 on bottom, 2 on left, 2 on right, 4 on rear 16 x M8 inserts on rear for optional castors 4 x brackets for optional transit cover
Dimensions	(W) 600 mm x (H) 509 mm x (D) 632 mm (760 mm with castors) (W) 23.6 in x (H) 20.0 in x (D) 24.9 in (29.9 in with castors)
Weight	47 kg (104 lbs)
Optional accessories	Set of four castors WHEELKIT (page 4) Weatherised connector cover WRKIT (page 4) Transit cover SXTCT118 (page 4) M10 eye bolt HTKCT06 (page 4) Wind-up telescopic pole ASF20071 (page 4)

¹On-axis in open space (4 pi) at 1 m.

²Tested for 2 hours with band-limited pink noise as specified in AES2-1984 (r2003). Peak power defined as 6 dB above AES power.

³In half space (2 pi) at 1 m with 1 watt input and band-limited pink noise.

SX118 technical drawing

- The drawing below shows the SX118 with castors. These are an optional accessory.
- To load this drawing into CAD software, see [DWG files \(page 16\)](#).

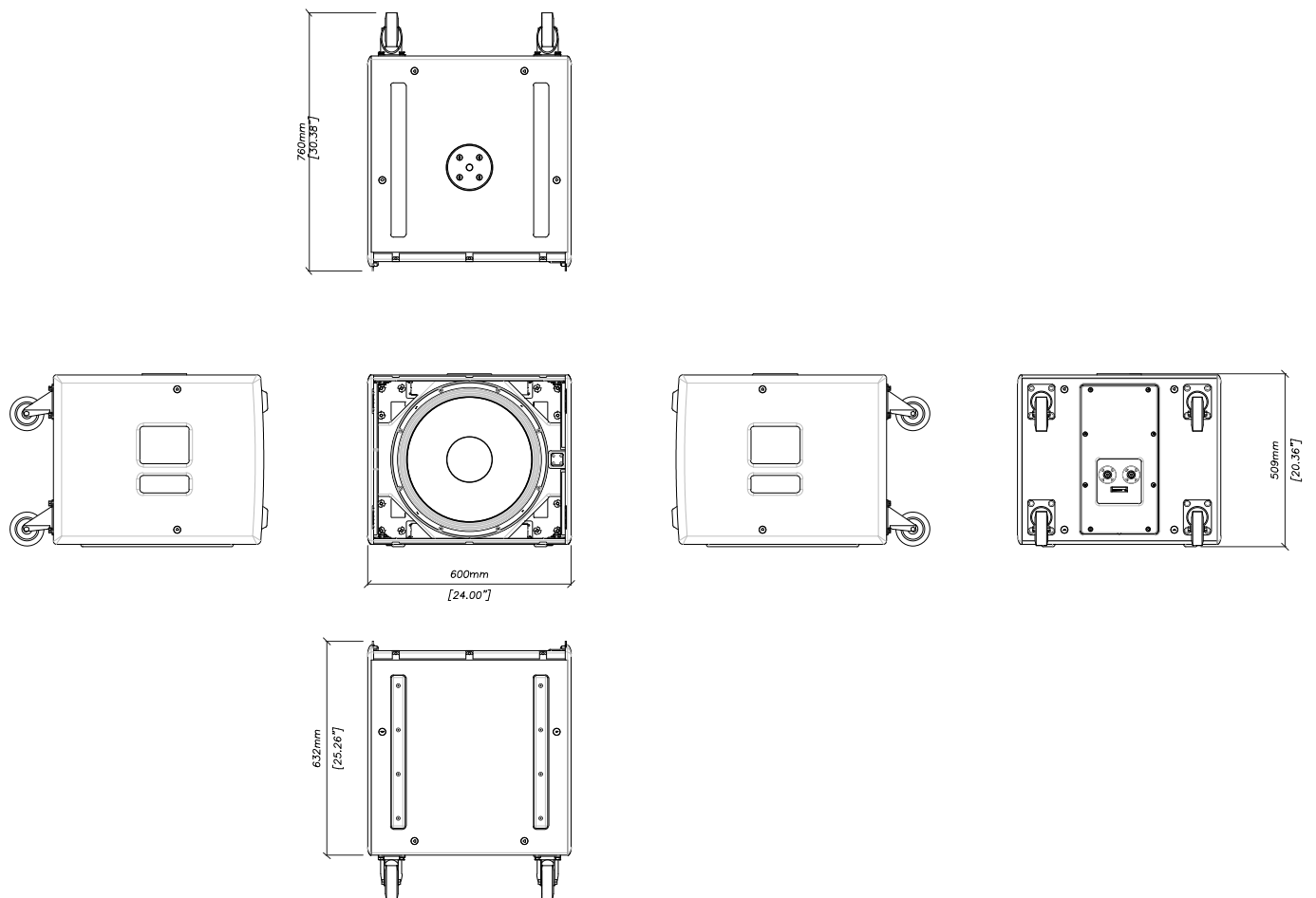

Troubleshooting

Sound not right. Make sure the input and output connectors are fully plugged into the sockets. Check the sound quality with headphones at the amplifier or preamp.

Technical support

For technical support, contact your supplier or Martin Audio. For Martin Audio technical support, visit martin-audio.com and select **Support > Support Contacts**.

Service

For service information, go to our website martin-audio.com and select **Support > Service & Returns**.

Warranty

For warranty information, go to our website martin-audio.com and select **Support > Service & Returns**.

Unpacking

After unpacking, carefully check your speakers for any signs of transit damage. If you find any issues, inform your dealer straight away. If possible, keep the packaging for future use.

Recycling

When the product reaches the end of its life, please dispose of it responsibly at a recycling centre.

Martin Audio Limited

Century Point

Halifax Road

Cressex Business Park

High Wycombe

Buckinghamshire

HP12 3SL

England

FOR SALES ENQUIRIES

UK

+44 1494 535 312

info@martin-audio.com

NORTH AMERICA

+1 323 381 5310

www.martin-audio.com

Martin Audio, the Martin Audio logo and Hybrid are registered trademarks of Martin Audio Ltd. in the United Kingdom, United States and other countries; all other Martin Audio trademarks are the property of Martin Audio Ltd.

